



Adeo Screen's innovative in-ceiling model InSuperior, with newly designed casing that can be integrated into a ceiling or false ceiling, features the new tensioning system with double lower bar and patented FTST<sup>™</sup> Floating Tensio System.

A weight-efficient structure that eliminates deformation of the roller assembly structure allows to use more rigid fabrics can be used and in larger sizes, offering the option of longer custom drop combinations.

This screen solution also allows a more convenient and quick installation thanks to the improved new installation brackets and the new lateral cover with magnets system. In addition the casing is provided with new safety cables.

#### Create your own screen with the PSS:

- > **personalized dimensions:** width and height
- > **roller type:** motorized or radio integrated
- > **case:** available only with case
- > **case color:** available only in white
- > **projection surfaces:** ReferenceWhite, ReferenceGrey, VisionWhite, VisionWhitePro and VisionAcoustik only with black border
- > **height of top:** from 5 to 150 cm
- > **projection surface drop:** front or rear
- > **side of command/motor:** right and left

#### Standard accessories:

- > kit containing eight 50 cm threaded bars for installation with maximum height of 1 m
- > unipolar selector switch
- > remote control (only for radio-integrated version)
- > end plates for closing the plasterboard

#### Optional accessories:

- > receiver and RF remote control for motorized screen (3 modalities: basic, automatic and compatible with domotic systems)
- > receiver and infrared remote control
- > bracket extensions for screens up to 60 cm

#### FTST<sup>™</sup> Floating Tensio System

Tensioning system consisting of a double lowbar and tensioning cables. Lowbar consist of two weights, one of which is responsible for the vertical force of the material and the other associated with the tensioning cable system is responsible for the flatness of the material horizontally.

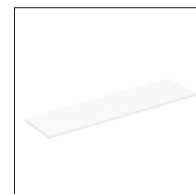

Surfaces Fireproof  
Certification

B1

M1

#### Standard formats

2.35:1	1.78:1	1.6:1	1.33:1
21:9	16:9	16:10	4:3

#### PSS formats

2.35:1	1.85:1	1.6:1	1.25:1	1.00:1
21:9		16:10	5:4	1:1

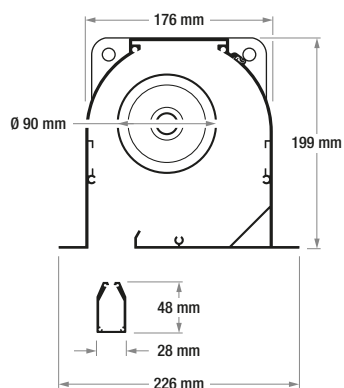

\* Up to 250 cm base

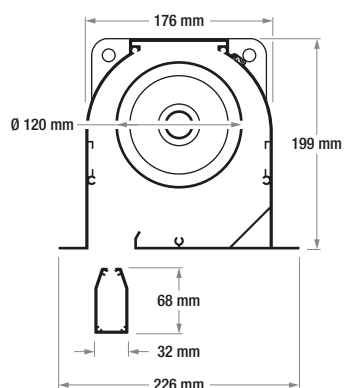

\* From 250 cm base

\* In certain circumstances due to the surface's height it is necessary to use a case with the rolling tube of 80 mm

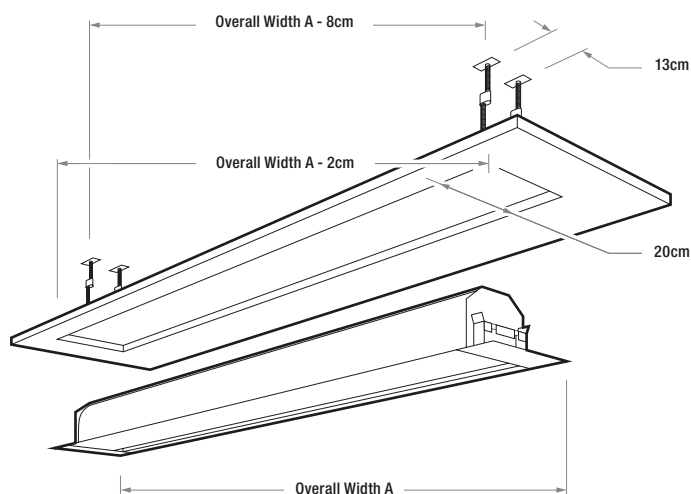

Format	Overall Width	Overall Height	Lowbar Width	Surface Height	Net Surface Width	Net Surface Height	Standard Top	Maximum Total Top	Diagonal Inches	Shipment Sizes	Net Weight	Gross Weight
	A	E	F	G	H	I	P	cm	O	cm	kg	kg
4:3	245	228	229	160	200	150	5	140	98	255x34x46	61	71
	299	265	283	198	250	188	5	140	123	309x34x46	71	81
	362	322	346	240	300	225	10	130	148	372x34x46	79	90
	417	359	401	278	350	263	10	130	172	427x34x46	87	99
	472	397	456	315	400	300	10	130	197	482x34x46	93	106
	529	434	513	353	450	338	10	130	221	539x34x46	110	123
16:9	245	190	229	122	200	112	5	140	90	255x34x46	61	71
	299	218	283	150	250	140	5	140	113	309x34x46	71	81
	362	265	346	184	300	169	10	130	135	372x34x46	79	90
	417	293	401	212	350	197	10	130	158	427x34x46	87	99
	472	322	456	240	400	225	10	130	181	482x34x46	93	106
	529	350	513	268	450	253	10	130	203	539x34x46	110	123
16:10	245	203	229	135	200	125	5	140	93	255x34x46	61	71
	299	234	283	166	250	156	5	140	116	309x34x46	71	81
	362	284	346	203	300	188	10	130	139	372x34x46	79	90
	417	316	401	234	350	219	10	130	162	427x34x46	87	99
	472	347	456	265	400	250	10	130	186	482x34x46	93	106
	529	378	513	296	450	281	10	130	209	539x34x46	110	123
21:9	245	163	229	95	200	85	5	150	86	255x34x46	61	71
	299	184	283	116	250	106	5	150	107	309x34x46	71	81
	362	224	346	143	300	128	10	140	128	372x34x46	79	90
	417	246	401	164	350	149	10	140	150	427x34x46	87	99
	472	267	456	185	400	170	10	140	171	482x34x46	93	106
	529	288	513	206	450	191	10	140	193	539x34x46	110	123

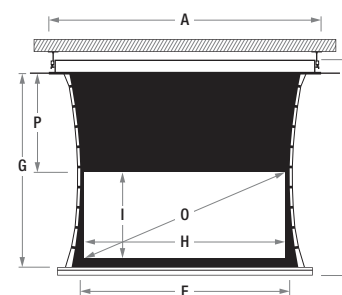

Please note that overall width only refers to screens with standard Top.

For configurations with bigger Tops please contact customer office.