

Instruction Manual

To our Customers:

Thank you for purchasing this.

This manual deals with the infrared remote controller and the receiver. Please refer to the screen manual for the operations of the electric screen.

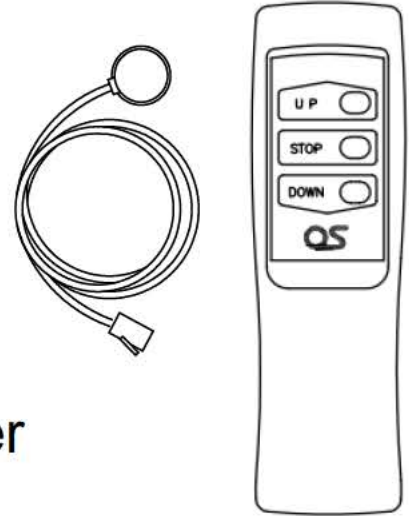

S-R1 / Infrared Remote Controller

Index

| | |
|--------------------------------------|-----|
| Safety Precautions | 2~3 |
| Accessories | 4 |
| Cautions in handling | 4 |
| Fitting the Infrared receiver | 5 |
| Preparation of the remote controller | 5 |
| How to use | 6 |
| Change of projection position | 6~7 |
| FAQ | 8 |

- Please kindly read this instruction manual carefully and use the product properly. This manual should be kept for future reference.

Safety Precautions

Please strictly comply with the following for safety

This instruction manual is intended to prevent any danger to the user and the third parties, or any damage to the property. The following indicators are to remind users to strictly observe the instructions.

- Throughout our explanation, the possible damage which may be caused by any negligence or disregard of the safety precaution is classified to different levels according to



WARNING

This icon warns that it may cause death or casualty if not following the instruction closely.



CAUTION

This icon indicates that it may cause injury or damage to the property.

- For the precautions we recommend users to notice, we explain by using the following different categories (The following are just examples).



This icon suggests that the action is strictly prohibited.



This icon suggests that this is the necessary procedure to follow.



WARNING



Do not alter the design or dismantle.

The continuous use may cause a fire and an electric shock.

- Stop using it, and consult with the dealer or distributor.



Do not close a source of heat.

It may cause a fire.



CAUTION



Do not damage the Infrared receiver cable.

Don't damage, torture, twist, pull hard and bundle the cable. Do not bring close to the high temperature section or put a heavy thing onto it.



Do not pull in or pull out the Infrared receiver plug with a wet hand.

It may cause major failures.



Do not operate the Infrared receiver plug with a wet hand.

It may cause major failures.

CAUTION



Exchange the same two new batteries.

When an old battery is mixed, it may cause heat, liquid leakage and the explosion.



Make sure the Infrared receiver plug is inserted tightly.

It may cause major failures.



Pull out the plug, when smoke, heat, smell or strange noise happens.

It may cause major failures.



OS Screen would not be responsible for damage caused by improper installation or natural disaster factors.

Accessories

Please confirm if every accessories are ready. If anything is missing, please contact the dealer or distributor.



Infrared remote controller × 1

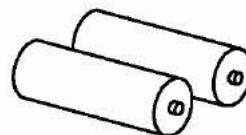

AAA dry batteries × 2



Infrared receiver × 1



Spare sticker(spare) × 1

Cautions in handling

- Please comply with the following cautions carefully, when you use the product.
- The distance the remote controller can be used is subject to the various environments, and can sometimes be shorter.
- Do not use in the rain and water because it is not waterproof.
- Change the two AAA batteries to the new ones when the signal is weak.
- Do not put in the back pocket of your trousers. When you sit down, the pressure might damage the remote controller.
- When it is dirty, remove the dust with the soft dry cloth.
- Never use a chemicals such as benzene, thinner etc. for cleaning.
- Do not drop the remote controller or give a strong shock.
- Do not store it in the direct sunshine area.

Fitting the Infrared receiver



CAUTION

Make sure the power is off when you connect it to the screen. It may destroy the product.

Plug in the Infrared receiver plug tightly. If not, it may cause mal-functioning.

1. Connect the modular plug of the Infrared receiver to the modular jack

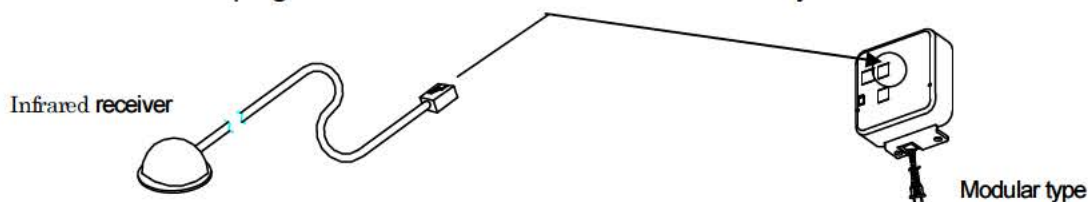

2. Remove the dust, water, oil and moist on the location, and stick the Infrared receiver tightly, peeling the coated paper off. The location should be where the signal of the infrared remote controller can reach. Avoid the direct sunshine area.

Things to know:

- When the reception is weak because of the direct sunshine, the infrared receiver location should be changed.
- There are locations where the infrared receiver cannot be stuck.
- Use the spare sticker, when the adhesive power of the pad is weak.

Preparation of the remote controller

Please pull out the back panel of the remote controller, and put two dry batteries (size AAA).

Dry batteries

- Change the two batteries to the new ones when the signal is weak.
- Take out all the batteries when you do not use it for long to avoid the liquid leakage damage
- Do not use rechargeable batteries.

Batteries (UM4)
Make sure + and - are correct.

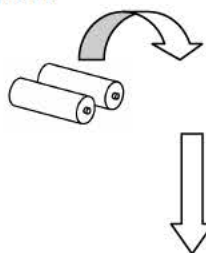

The operation range of Infrared remote controller

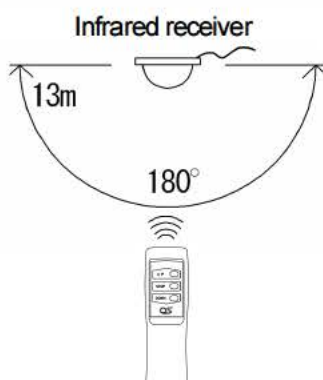

Remote controller

- Do not drop, throw away, or put water on it, or it may cause the breakdown.
- Handle the remote controller carefully.
- Please operate it to the direction of the infrared receiver

How to use

■ Storing the screen

When the screen is deployed, push the **UP** button of the remote controller.

The screen is rolled up and stored, and it stops automatically.

■ Stopping the screen

Please push the **STOP** button whenever you want to stop the operation.

■ Deploying the screen

Please confirm the screen is stored, and push the **DOWN** button of the remote controller. The screen is deployed to a prescribed projection position, and it stops automatically.

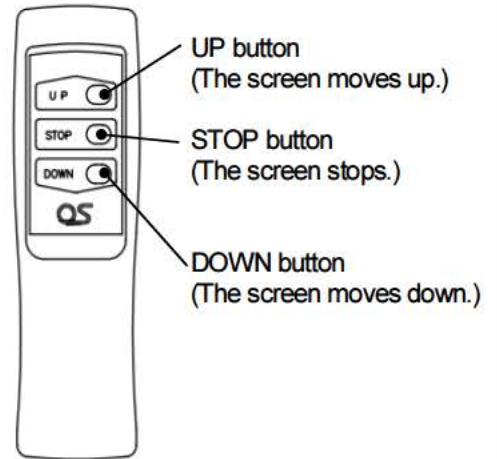

CAUTION

Pull out the power plug, when the screen is not used for long.
The leak may cause a fire.

Change of projection position

- The projection position can be changed as desired.

● To lift up the projection position

① Stop at the desired position

Use **UP** & **DOWN** buttons and push **STOP** button at the desired position.

② Memorizing the position

1. At the desired position, push **STOP** button for 5-6 seconds, and then push **DOWN** button within 2 seconds.
2. Upon receiving the command, the screen moves up approx. 10cm, and then stops at the preset position.

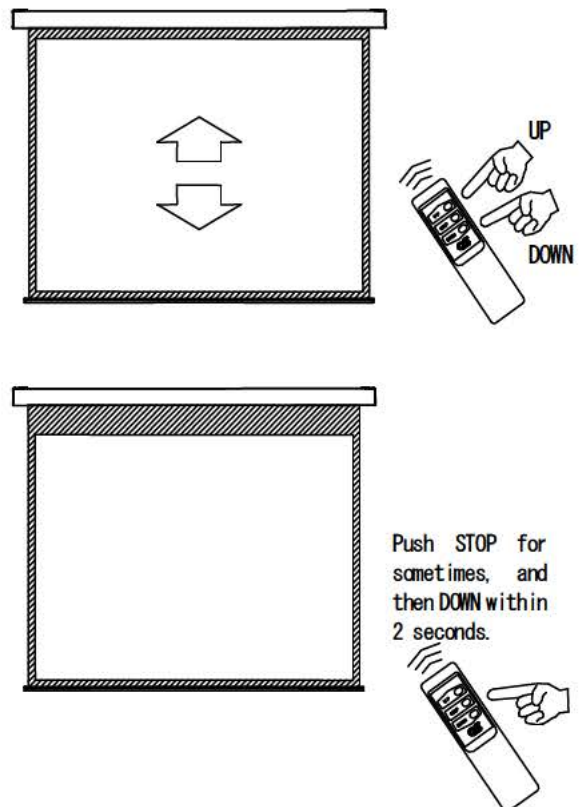

● To lift down the projection position

① Deploy the screen

Push **DOWN** button for 5-6 seconds and the screen starts to come down from the preset position.

Push **STOP** button.

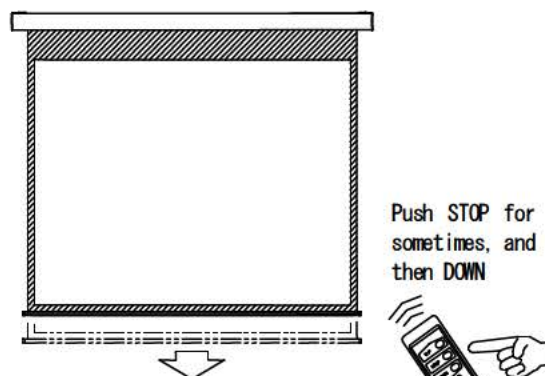

② Stop at the desired position

Use **UP** & **DOWN** buttons and push **STOP** button at the desired position.

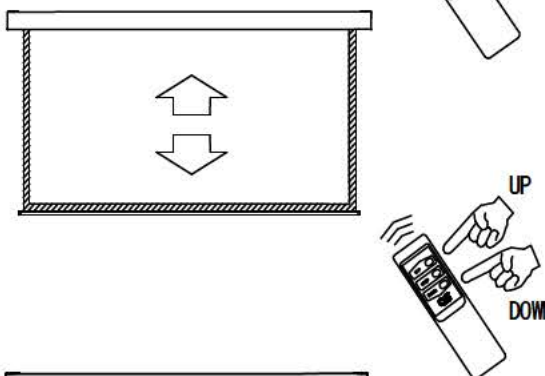

③ Memorizing the position

3. 1. At the desired position, push **STOP** button

for 5-6 seconds, and then push

DOWN button within 2 seconds.

Upon receiving the command, the screen moves up approx. 10cm, and then stops at the preset position.

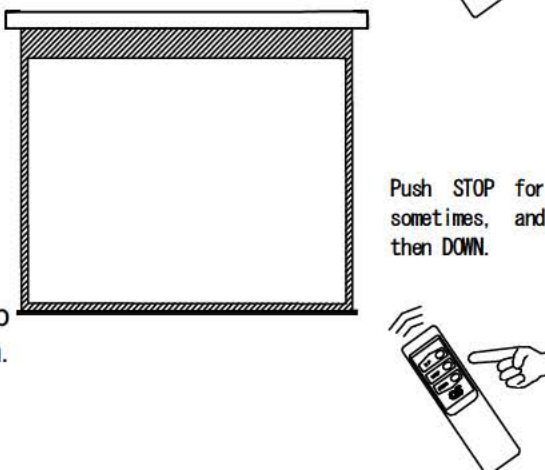

※NOTICE If the **DOWN** button is pushed for some time and left as it is, the screen comes to the factory default position, and stops. The screen cannot be lower than this position.

FAQ

In case of malfunctions, please refer to the following table before asking for the repair work. Make sure the power plug is disconnected before checking. If the problem is not solved, please consult with the dealer or the distributor.

| Symptom | Check | Remedy |
|--|--|---|
| The screen does not operate | Is power plug fixed to the mains correctly? | Fix the plug tightly. |
| | Is the remote controller directed to the receiver? | Direct the remote controller to the receiver. |
| | Anything blocking between the remote and receiver? | Take off the blocking item, or change the receiver position. |
| | Is the sun or lights reflected on the receiver? | Change the position of the receiver |
| | Batteries of remote low? | Change the two batteries in the remote.(AAA type) |
| | Is the heat prevention circuitry on? | Cool off the motor and operate again after 10-20 minutes. Reset the stored position, using UP operation. |
| | Is the receiver cable extended? | If the receiver cable is extended, it is easily affected by the noises. Any modifications on the product or the accessories would be subject to non-warranty. |
| | Is there a power failure during operation? | If the power fails during operation, UP or DOWN operation restores the screen to reset. |
| No adjustments on the lift down position | Conf Infrared in the procedures explained in the manual. | Store up the screen, and wait more than 1 second for re-setting. |

OSI CO., LTD.

Room 1605, 16/F, Seaview Centre, 139 Hoi Bun Road,
Kwun Tong, Kowloon, Hong Kong

PHONE : +852-3580-0087 FAX : +852-2367-4300

E-mail : info-hk@os-worldwide.com

U R L : <http://www.os-worldwide.com>