

TP

【Material lineup】
HF102 WF302

OS SCREEN

4K SCREEN

HDR High Dynamic Range Screen

ASPECT RATIO
16:9

P Selection

Side tension

elec

ULTRA SHORT THROW PROJECTOR RECOMMENDATION

Ideal flatness with the latest developments in high quality pictures.
Supporting ultra short throw projector tab tension electric screen.

- A tab tension electric screen with superior flatness comparable to a fixed frame type.
- A tab tension mechanism that applies tension from left and right of the screen.
- Simple design with flat panel.
- P selection mechanism enabled the material exchange.

[Dimensional drawing]

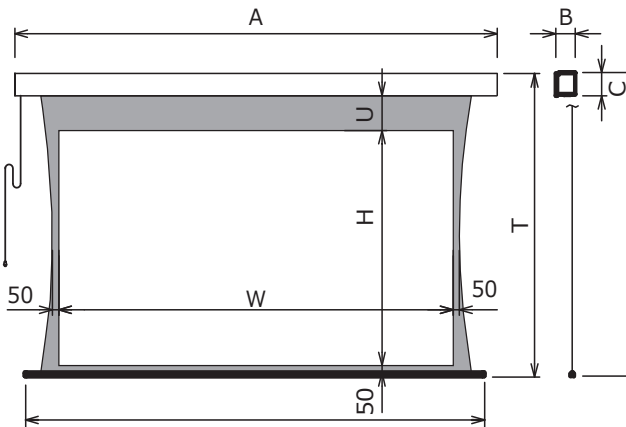

Panel color is luxurious black.

Mounting brackets are equipped with sliding and side bracket as standard

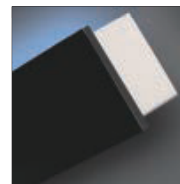

Panel color (Black)



Sliding bracket
(Except 130" ~ 150")
1 set: 2 pairs



Side bracket
(130" ~ 150" are case integrated type)
1 set: 2 pairs

[HD 16:9] Please specify the model code for "x1x" to refer "How to understand the model code".

Diagonal size (inch)	Model	Image size W×H (mm)	Length A (mm)	Height T (mm)	UBB U (mm)	Depth B (mm)	Height when in stored C (mm)
80	TP-080HM-x1x	1771×996	2304	2223 2217	1004	134 135	145 139
90	TP-090HM-x1x	1992×1121	2525		879		
100	TP-100HM-x1x	2214×1245	2747		755		
110	TP-110HM-x1x	2435×1370	2968		630		
120	TP-120HM-x1x	2657×1494	3190	2248	506	155	170
130	TP-130HM-x1x	2878×1619	3411		381		
140	TP-140HM-x1x	3099×1743	3632		257		

* The numbers of (T),(B) and (C) above indicate when sliding bracket is used and the numbers below indicate when side bracket is used.

[Material lineup]

Diagonal size (inch)	Model	Applicable screen materials	
80	TP-080HM-x1x	HF102	WF302
90	TP-090HM-x1x	HF102	WF302
100	TP-100HM-x1x	HF102	WF302
110	TP-110HM-x1x	HF102	WF302
120	TP-120HM-x1x	HF102	WF302
130	TP-130HM-x1x	HF102	WF302
140	TP-140HM-x1x	HF102	WF302

(NTSC (4:3), WXGA (16:10), Cinema Scope (2.35:1) are available on your request.)

Sold by

OSI CO., LTD.



20th Floor, Wah Hing Commercial Building, 283 Lockhart Road, Wanchai, Hong Kong

Tel. +852-3580-0087 Fax. +852-2367-4300

<https://hk.os-worldwide.com/> info-hk@os-worldwide.com

OSI CO., LTD.